

STATE OF NORTH CAROLINA
DEPARTMENT OF TRANSPORTATION
HIGHWAY DIVISION 6

PLANS

Letting Date: October 6, 2021

CONTRACT ID: DF00292

TIP NO.: -----

FEDERAL AID NO.: STATE FUNDED

WBS ELEMENT NO.: 2022CPT.06.06.10781.1 & 2022CPT.06.06.20781.1

ROUTE NO.: US 301, US 501 & VARIOUS SR ROUTES

LOCATION: VARIES

COUNTY: ROBESON

LENGTH OF PROJECT: 21.06 MILES

TYPE OF WORK: RESURFACING, MILLING, WIDENING & PVT. MKGS.

**This electronic collection of documents is provided
for the convenience of the user
and is Not a Certified Document –**

**The documents contained herein were originally issued
and sealed by the individuals whose names and license
numbers appear on each page, on the dates appearing
with their signature on that page.**

**This file or an individual page
shall not be considered a certified document.**

**ROBESON COUNTY
RESURFACING
FALL 2021**



SOUTH CAROLINA

Rowland

Echo

1

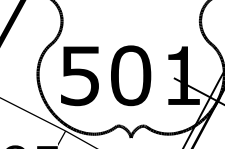
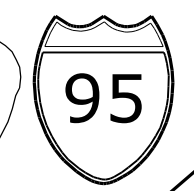
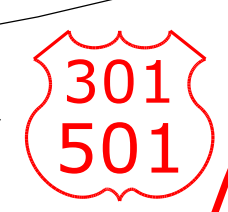

REVISIONS

8/17/99

03/25/2021
 ROBESON COUNTY
 ENGINEERING
 1111065320318

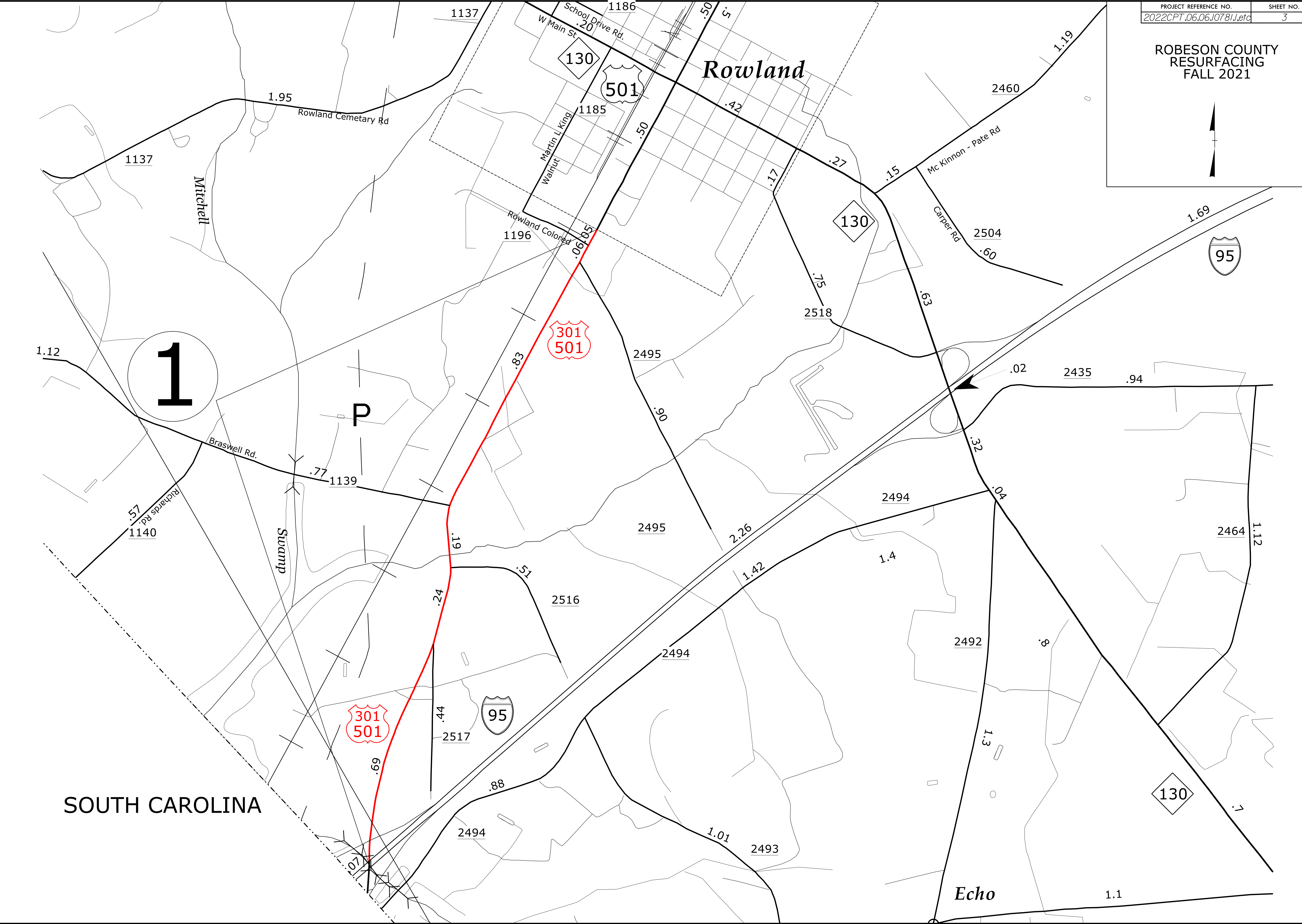

ROBESON COUNTY RESURFACING FALL 2021

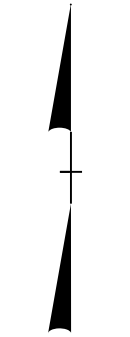

Maxton

SCOTLAND COUNTY

SOUTH CAROLINA

REVISIONS

8/17/99

92-SEP-2021 10:56 AM Work Files\Projects\Resurfacing\2021 Fall\11\Contract\ROBESON_MS-ENG.cdw
S:\Users\A111111111\Documents\2021 Fall\11\Contract\ROBESON_MS-ENG.cdw

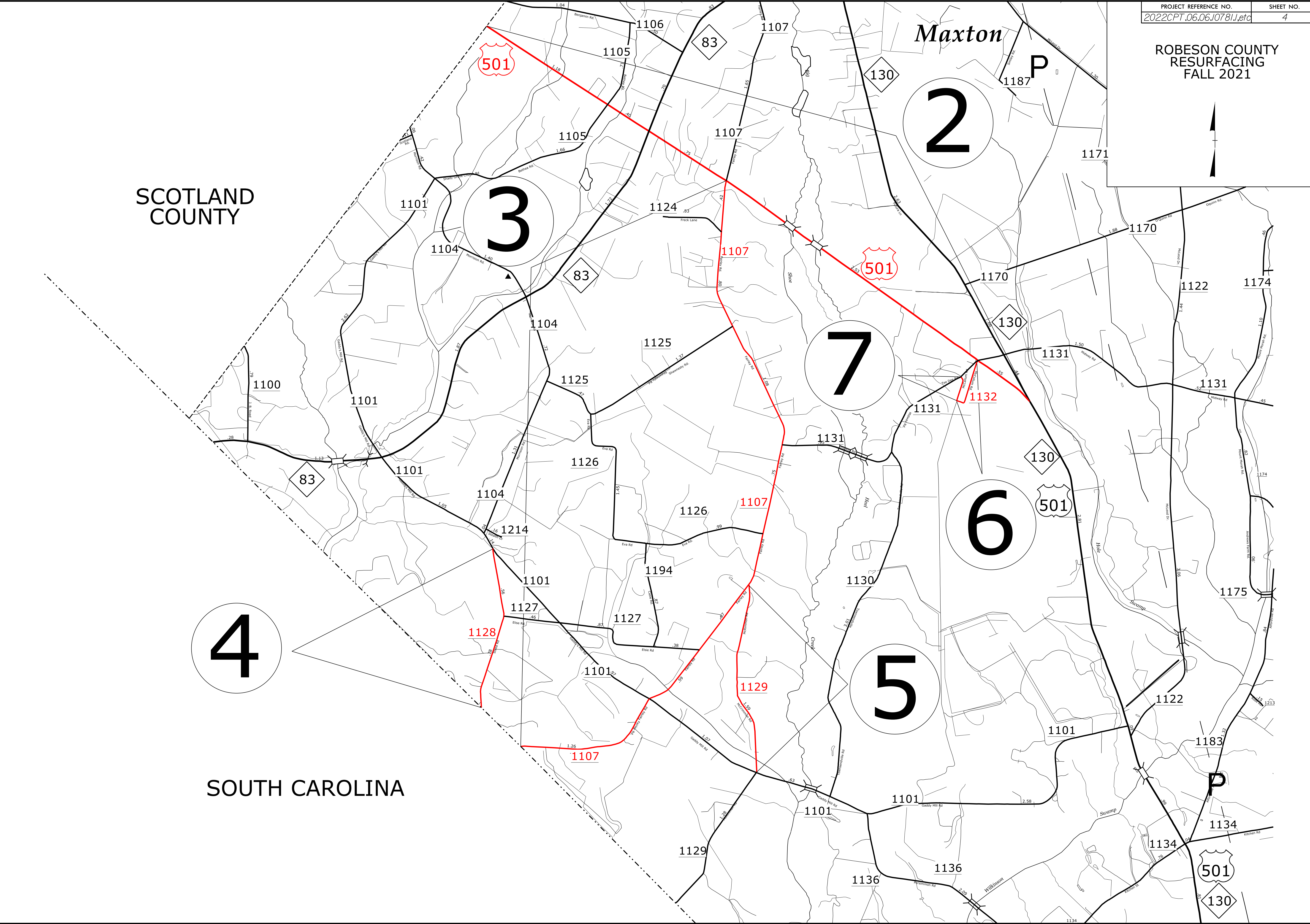

ROBESON COUNTY
RESURFACING
FALL 2021

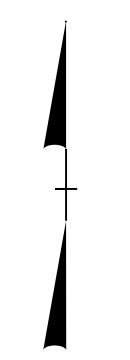

8/17/99

REVISIONS

93-SEP-2020 08:32 Work Files\Projects\Resurfacing\2021 Fall\1\Contract\ROBESON.MS_ENG.dgn
S:\Users\A1111106\202108-202108

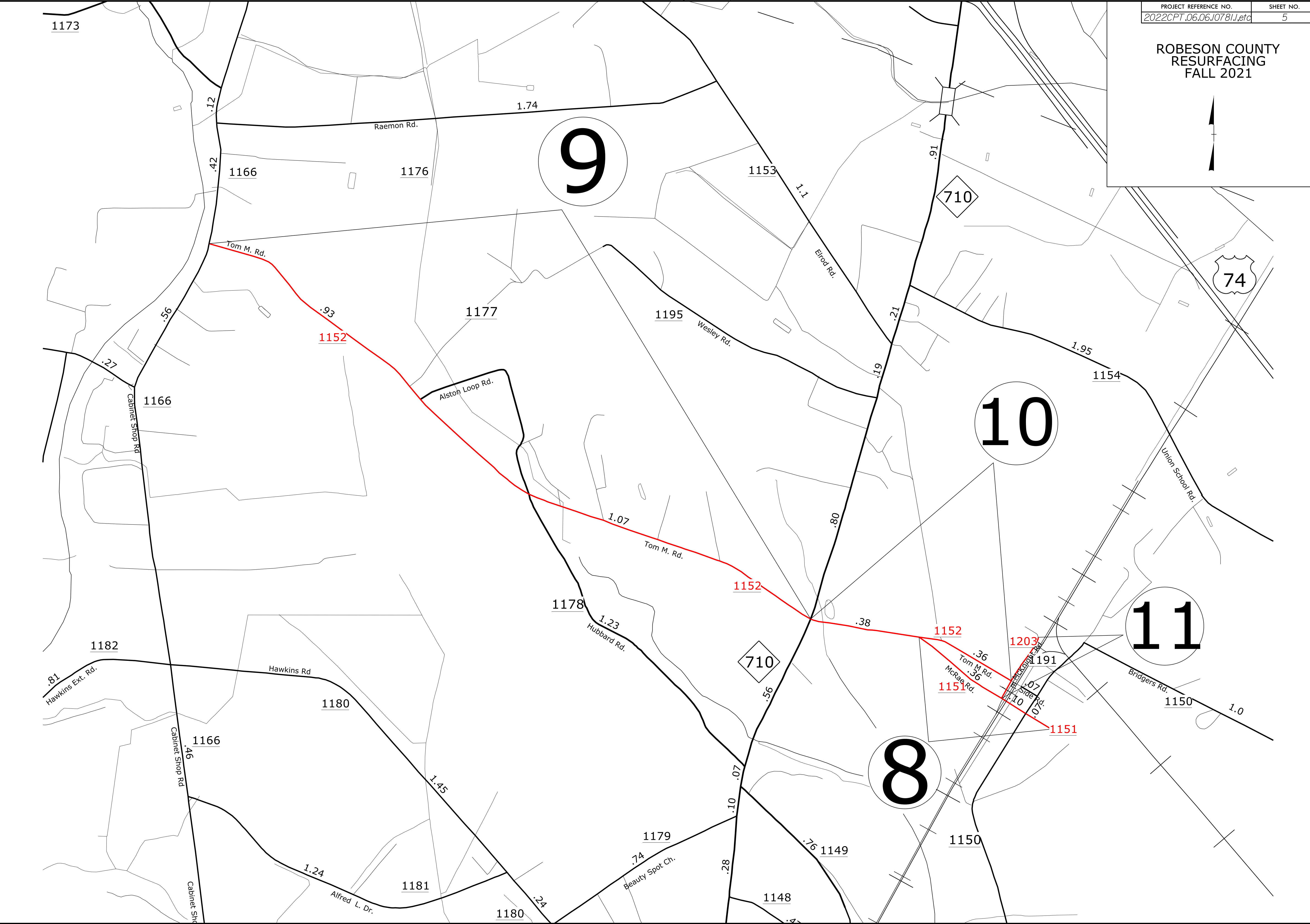

1173

1.74

9

.12

1166

1176

1153

1.1

.91

710

74

Tom M. Rd.

1152

.93

1177

1195

Wesley Rd.

.21

Elrod Rd.

1.95

1154

.27

1166

Cabinet Shop Rd

Alston Loop Rd.

1.07

1152

Tom M. Rd.

.80

10

Union School Rd.

1178

1.23

Hubbard Rd.

.38

1152

11

.81

1182

Hawkins Ext. Rd.

Hawkins Rd

1180

710

.56

1151

1203

.36

Tom M. Rd.

1151

McRae Rd.

.07

1191

Side Rd.

Bridgers Rd.

1150

1.0

1166

Cabinet Shop Rd

.46

1.45

1181

1.24

Alfred L. Dr.

.74

1179

Beauty Spot Ch.

.10

.28

1148

.76

1149

8

1150

1180

.24

PAVEMENT SCHEDULE

C1	1½" ASPHALT CONCRETE SURFACE COURSE, TYPE S9.5B, AT AN AVERAGE RATE OF 165 LBS. PER SQ. YD.
C2	1½" ASPHALT CONCRETE SURFACE COURSE, TYPE S9.5C, AT AN AVERAGE RATE OF 168 LBS. PER SQ. YD.
D1	2½" ASPHALT CONCRETE INTERMEDIATE COURSE, TYPE I19.0C, AT AN AVERAGE RATE OF 285 LBS. PER SQ. YD.
E1	3" ASPHALT CONCRETE BASE COURSE, TYPE B25.0C, AT AN AVERAGE RATE OF 342 LBS. PER SQ. YD.
E2	5½" ASPHALT CONCRETE BASE COURSE, TYPE B25.0C, AT AN AVERAGE RATE OF 342 LBS. PER SQ. YD.
T1	SHOULDER RECONSTRUCTION WITH AGGREGATE SHOULDER BORROW
U	EXISTING ASPHALT PAVEMENT
V1	0" - 1½" MILLING
V2	¾" MILLING
V3	1½" MILLING
V4	5½" MILLING

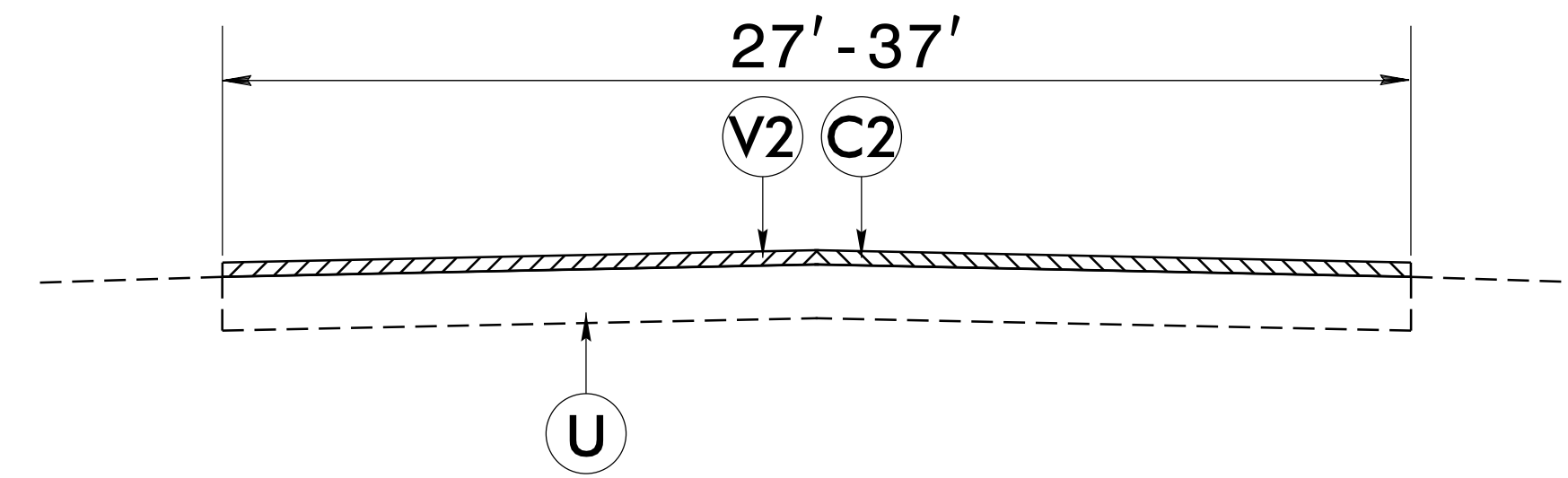

TYPICAL SECTION NO. 1

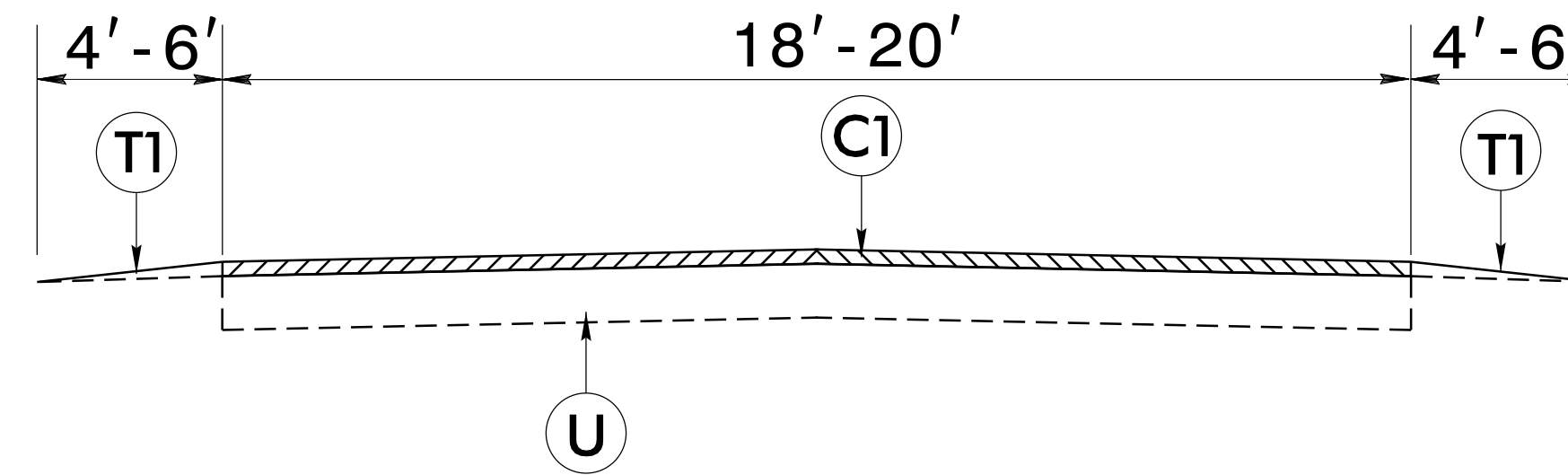

TYPICAL SECTION NO. 2

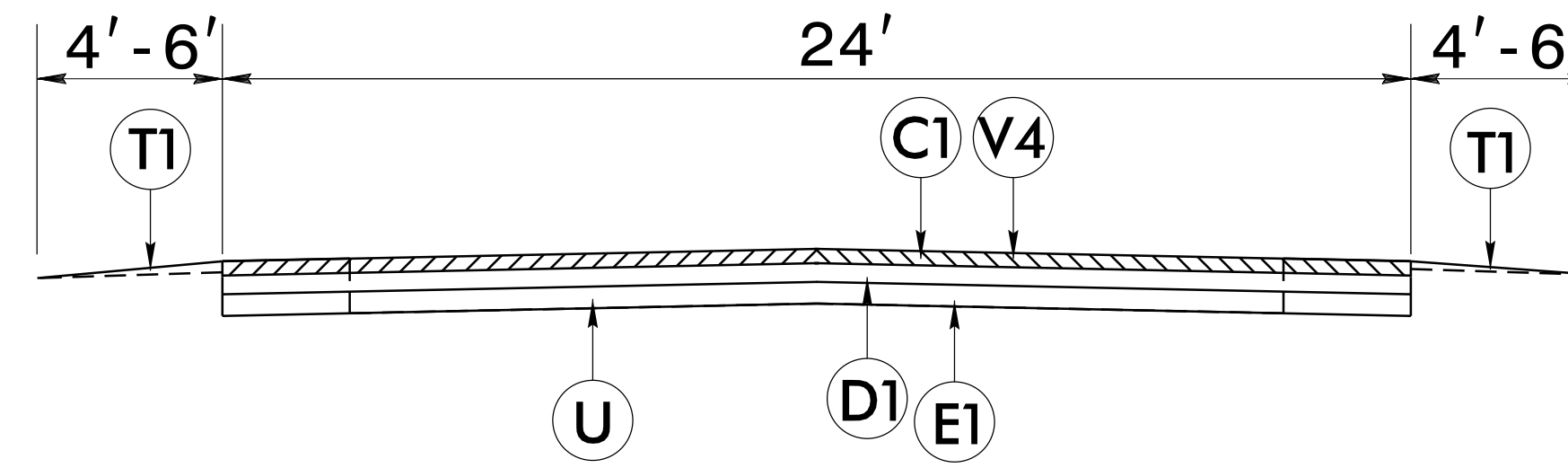

TYPICAL SECTION NO. 3

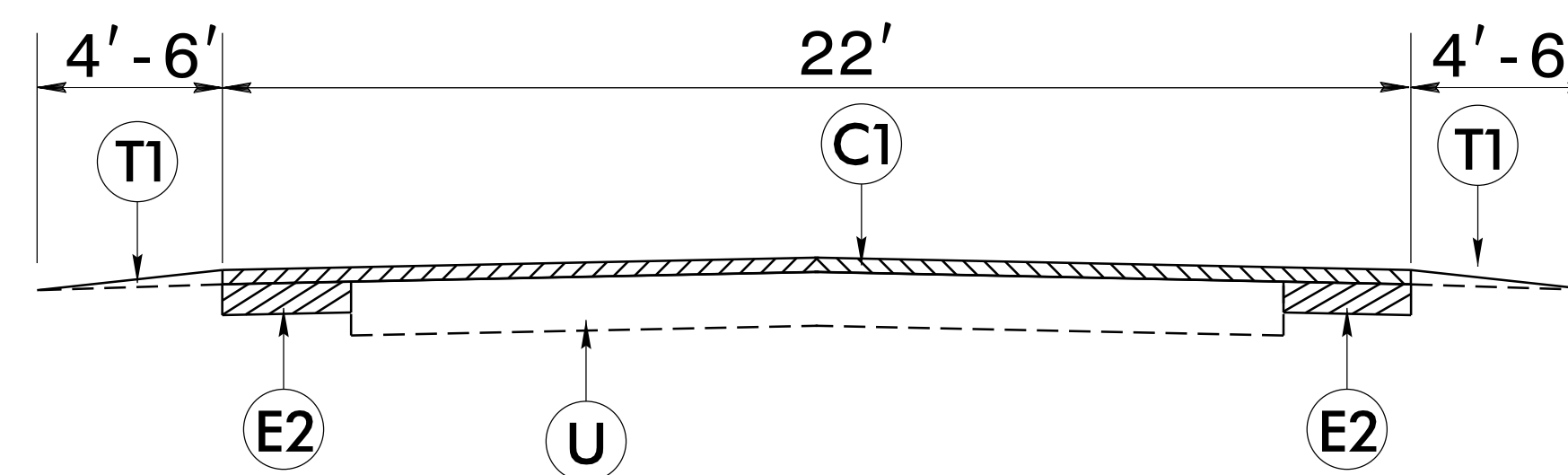

TYPICAL SECTION NO. 4

NOTES:

1. UPON COMPLETION OF SURFACE MILLING, TEMPORARY PAINT MARKINGS SHALL BE INSTALLED WITHIN TIME FRAME ESTABLISHED IN STD. SPECS.
2. CONTRACTOR SHALL BEGIN WIDENING AND/OR MILL & FILL OPERATION WITHIN 3 DAYS OF COMPLETING SURFACE MILLING.
3. CONTRACTOR SHALL BEGIN PLACEMENT OF FINAL SURFACE WITHIN 3 DAYS OF COMPLETING WIDENING AND/OR MILL & FILL OPERATION.
4. ALL MAPS SHOULD INCLUDE ADDITIONAL 2' INSIDE CURVE WIDENING (SEE DETAIL)

PAVEMENT SCHEDULE

C1	1½" ASPHALT CONCRETE SURFACE COURSE, TYPE S9.5B, AT AN AVERAGE RATE OF 165 LBS. PER SQ. YD.
C2	1½" ASPHALT CONCRETE SURFACE COURSE, TYPE S9.5C, AT AN AVERAGE RATE OF 168 LBS. PER SQ. YD.
D1	2½" ASPHALT CONCRETE INTERMEDIATE COURSE, TYPE I19.0C, AT AN AVERAGE RATE OF 285 LBS. PER SQ. YD.
E1	3" ASPHALT CONCRETE BASE COURSE, TYPE B25.0C, AT AN AVERAGE RATE OF 342 LBS. PER SQ. YD.
E2	5½" ASPHALT CONCRETE BASE COURSE, TYPE B25.0C, AT AN AVERAGE RATE OF 342 LBS. PER SQ. YD.
T1	SHOULDER RECONSTRUCTION WITH AGGREGATE SHOULDER BORROW
U	EXISTING ASPHALT PAVEMENT
V1	0" - 1½" MILLING
V2	¾" MILLING
V3	1½" MILLING
V4	5½" MILLING

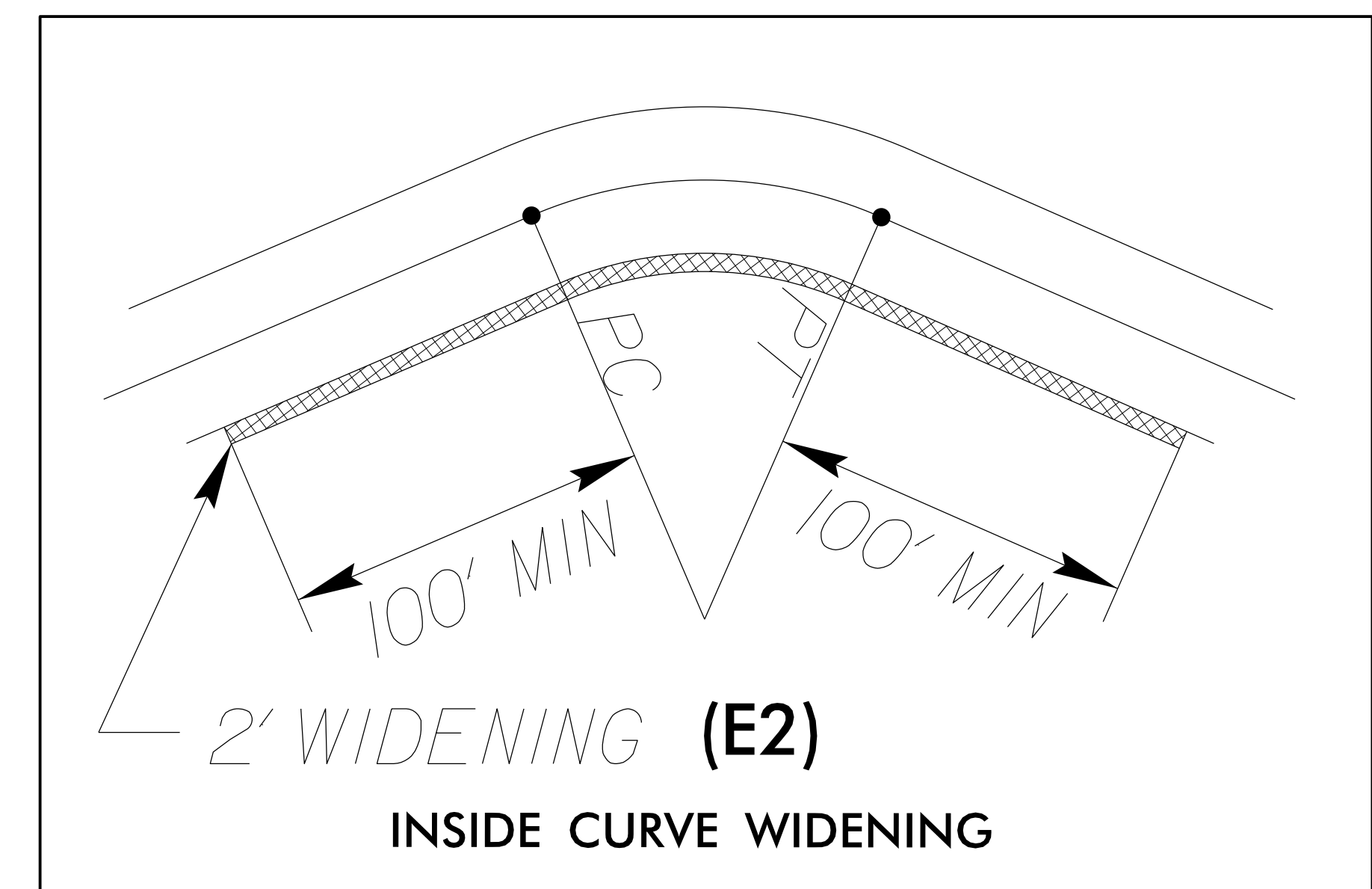
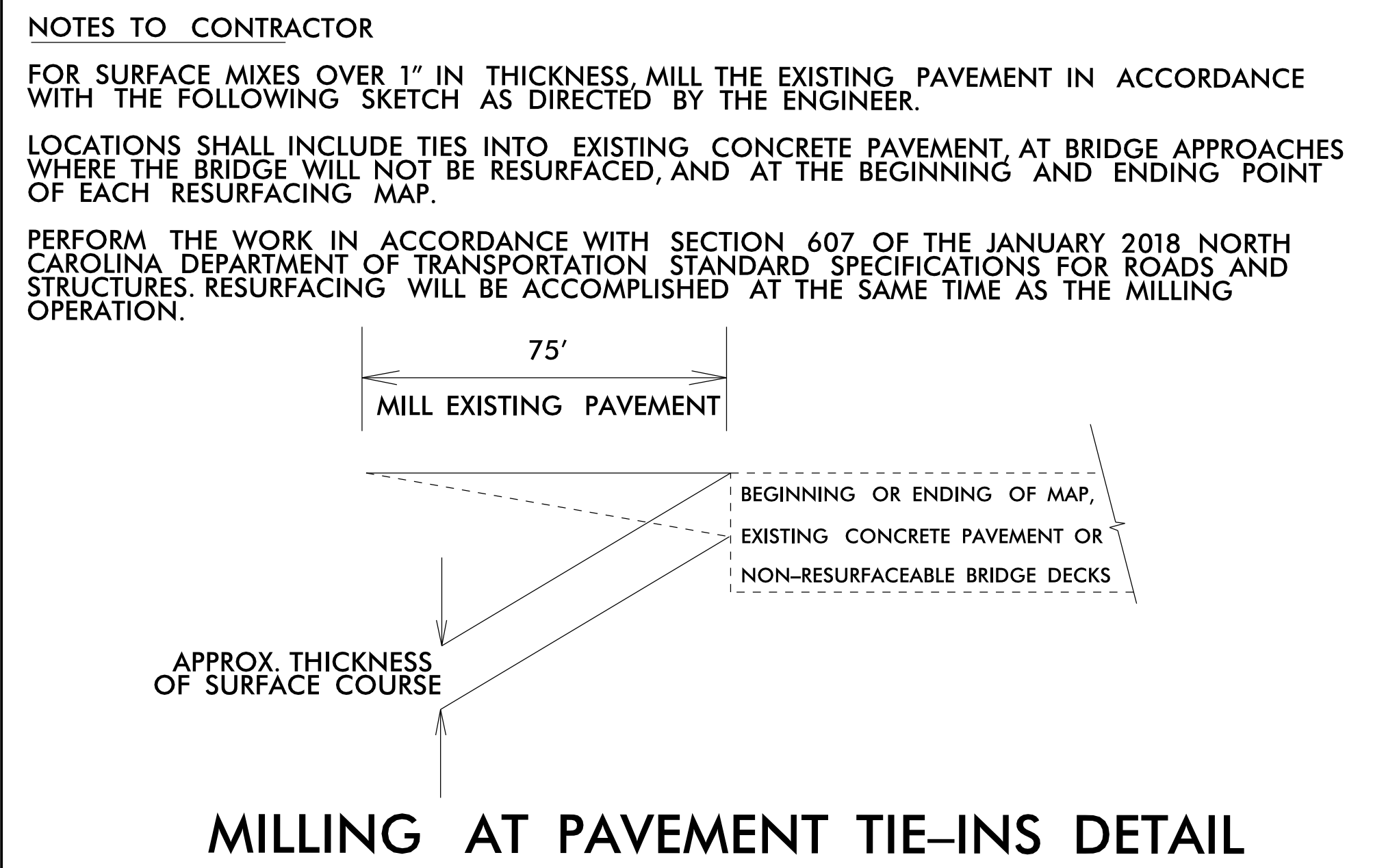
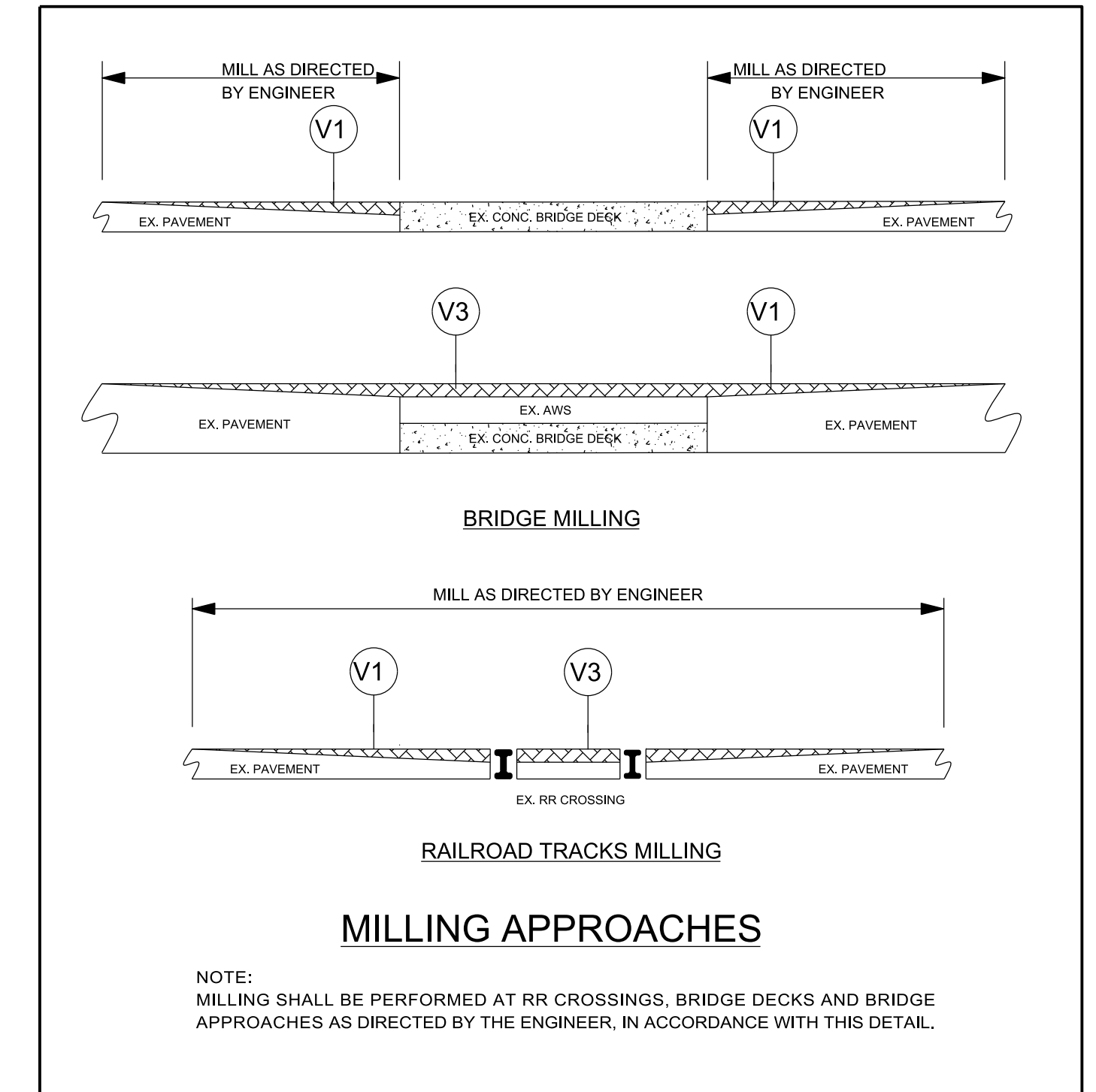
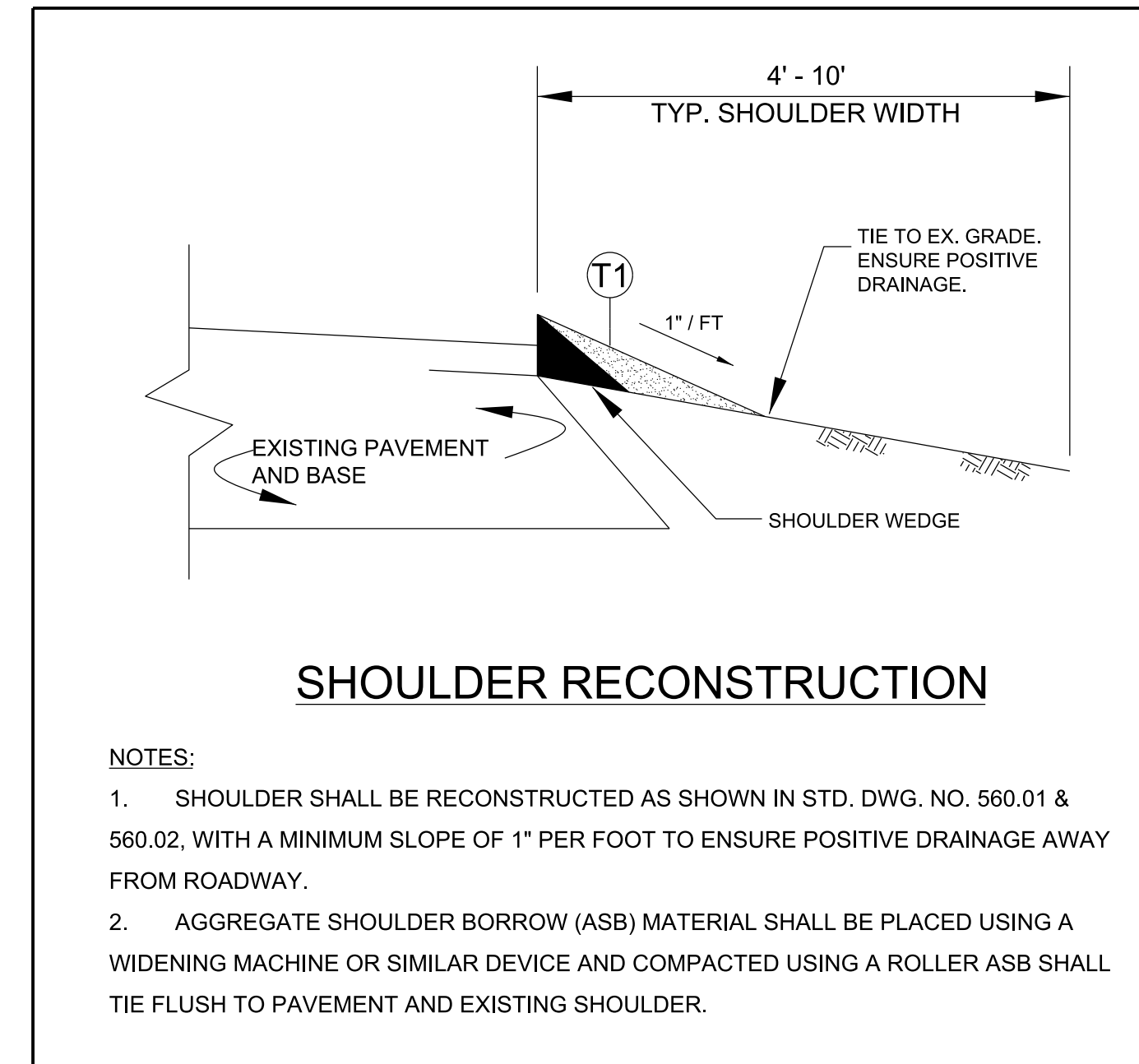

- NOTES:
- 1) DETAIL DOES NOT APPLY TO OGAFc AND ULTRA-THIN BONDED WEARING COURSE.
 - 2) BACKFILL SHOULDER WITH APPROVED MATERIAL.
 - 3) THE SHOULDER WEDGE DEVICE MAY BE DISENGAGED AT PAVED DRIVEWAYS AND SIDE STREETS.

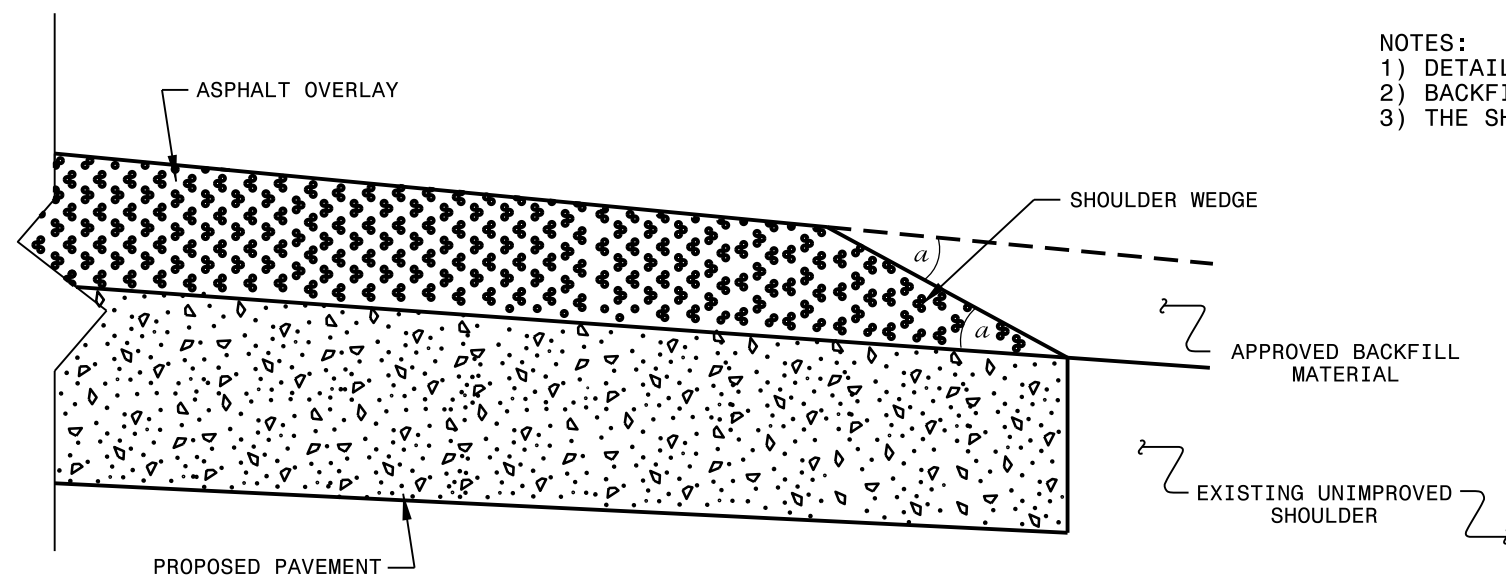

SHOULDER WEDGE DETAIL
(Resurfacing Projects w/ Widening or
with Existing Paved Shoulder having no dropoffs)

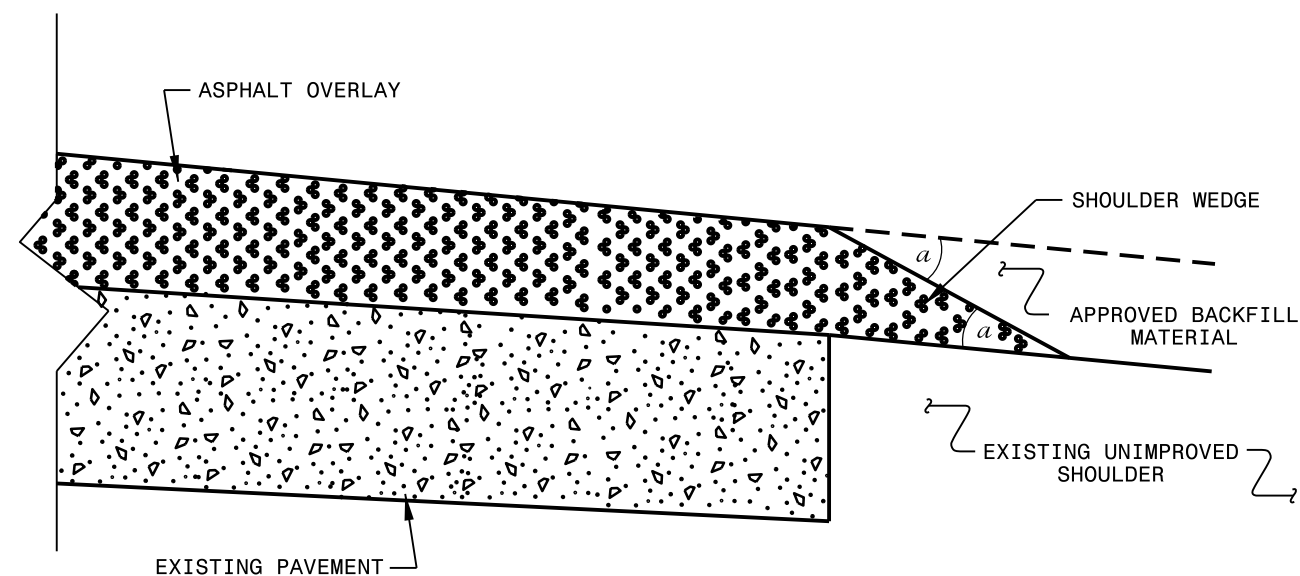

SHOULDER WEDGE DETAIL
(Resurfacing Projects w/ NO Widening)

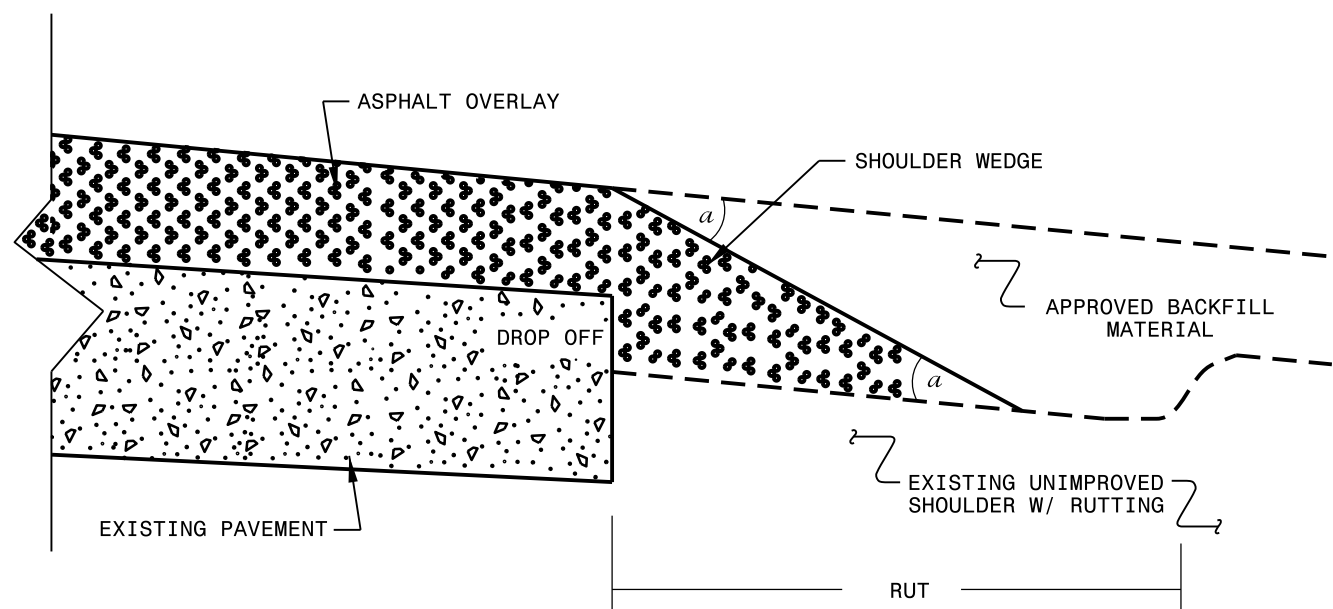

SHOULDER WEDGE DETAIL
(Resurfacing Adjacent to
Rutted Shoulder)

- SHOULDER WEDGE ANGLE = 30°

CONTRACT STANDARDS
AND DEVELOPMENT UNIT
Office 919-707-6950 FAX 919-250-4119

**SHOULDER WEDGE
DETAILS**

ORIGINAL BY: T.SPELL DATE: 7-19-11
 MODIFIED BY: DATE: 10/16/12
 CHECKED BY: DATE:
 FILE SPEC.: susr/details/stand/shoulderwedgedetail.dgn

SYSTEMS DESIGN
 USER NAME

SIGNING FOR RESURFACING PROJECTS

LEGEND

┆ STATIONARY SIGN

← DIRECTION OF TRAFFIC FLOW

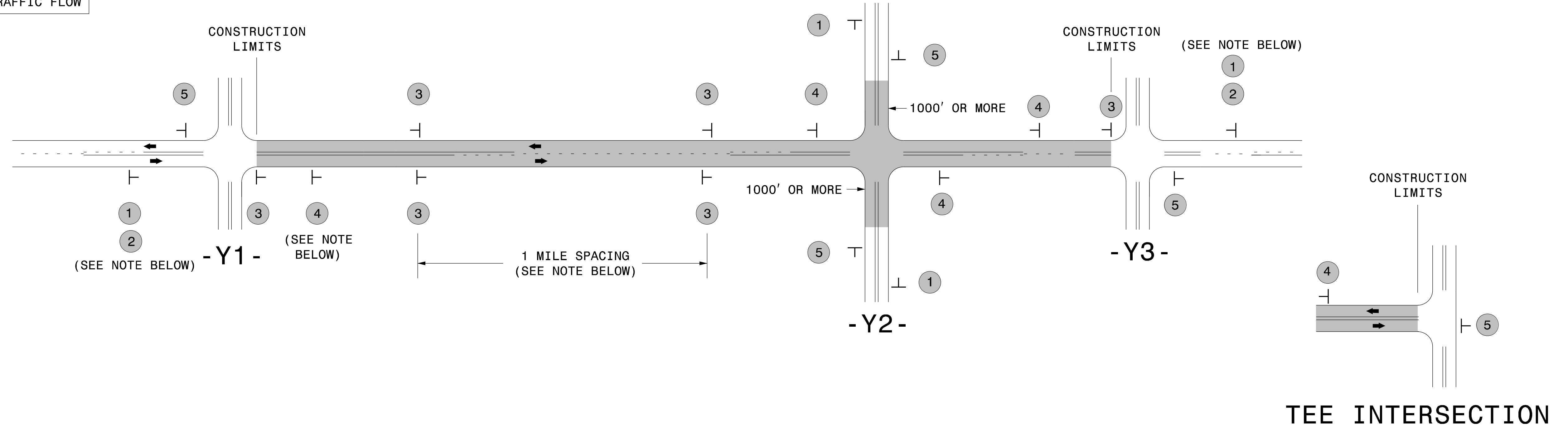

MAINLINE (-L-) SIGNING

-Y- LINE SIGNING

SIGNING NOTES AND PLACEMENT PER DIRECTION	1		PLACE 1000' PRIOR TO BEGINNING OF CONSTRUCTION LIMITS. ONLY USED ON -Y- LINES IF RESURFACING LIMITS EXTEND 1000' ALONG -Y- LINE.	<p>NO REQUIRED STATIONARY SIGNING FOR THE FOLLOWING -Y- LINE CONDITIONS:</p> <ol style="list-style-type: none"> LESS THAN 1000' OF RESURFACING ALONG -Y- LINE SUBDIVISION ROADS DEAD END ROADS <p>WHEN PAVING/CONSTRUCTION ACTIVITIES PROCEED ACROSS AN UNSIGNED -Y- LINE, PORTABLE ADVANCE WARNING SIGNS SHALL BE USED ALONG THE -Y- LINE AS SHOWN BELOW. REMOVE UPON COMPLETION OF WORK.</p> <div style="display: flex; justify-content: space-around;"> <div style="text-align: center;"> W20-1 48" X 48" PLACED 500' IN ADVANCE OF FLAGGER. </div> <div style="text-align: center;"> W20-7 A 48" X 48" PLACED 250' IN ADVANCE OF FLAGGER. </div> </div>
	2		#2 SIGN ONLY USED WHEN CONSTRUCTION LIMITS ARE 2 OR MORE MILES IN LENGTH. ROUND UP TO NEXT WHOLE NUMBER. (NO FRACTIONAL OR DECIMAL NUMBERS)	
	3		- PLACE INITIALLY AT THE CONSTRUCTION LIMITS AND SPACE 1 MILE APART THEREAFTER. - AT TEE INTERSECTIONS INSTALL INITIALLY 1/2 MILE FROM INTERSECTION AND SPACE 1 MILE APART THEREAFTER.	
	4		- THESE ARE FOR -Y- LINES THAT ARE "THROUGH" ROADWAYS. - DEAD END AND SUBDIVISION ROADS ARE NOT "THROUGH" ROADWAYS. - INSTALL 500' +/- FROM EACH -Y- LINE APPROACH AS SHOWN ABOVE. - FOR MULTIPLE -Y- LINES THAT ARE SEPARATED BY 0.25 MILES OR LESS, TREAT AS A SINGLE UNIT AND INSTALL WITHIN 500' OF EACH APPROACH. - A MAXIMUM OF 2 SIGN SETS PER MILE. DO NOT INSTALL WHEN -Y- LINES ARE WITHIN 0.5 MILES FROM "END ROAD WORK" SIGN. - FOR TEE INTERSECTIONS, INSTALL WITHIN 500' +/- OF THE INTERSECTION ALONG -L- LINE.	
	5		PLACE 500' FOLLOWING THE END OF CONSTRUCTION LIMITS OR AS SHOWN WHEN WORK ENDS AT A 3-WAY TEE INTERSECTION.	

THE ABOVE SIGNS ARE ALL THAT ARE REQUIRED FOR A CONTRACTOR TO BEGIN A RESURFACING CONTRACT. ANY ADDITIONAL SIGNS REQUESTED BY NCDOT DIVISIONS SHALL BE INSTALLED WITHIN 7 BUSINESS DAYS OF THE START OF CONTRACT WORK.

MAPS LESS THAN 2 MILES

FOR RESURFACING MAPS WITH CONSTRUCTION LIMITS LESS THAN 2 MILES IN LENGTH, NO STATIONARY SIGNS ARE REQUIRED. USE PORTABLE "ROAD UNDER CONSTRUCTION" OR "ROAD WORK AHEAD" SIGNS IN LIEU OF STATIONARY ADVANCE WARNINGS SIGNS.

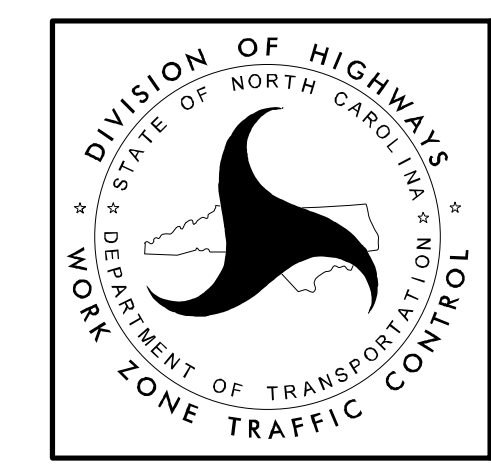

ADVANCE WARNING SIGNS FOR RURAL AND SUBURBAN 2-LANE ROADWAY RESURFACING

GUIDELINES FOR LANE WIDTHS ON RESURFACING PROJECTS

Contractor shall place the new pavement markings in accordance with this table and detail unless otherwise directed by the Engineer.

TWO LANE - TWO WAY ROADWAY - 55 MPH		
ROADWAY WIDTH	LANE WIDTH	SHOULDER WIDTH
18'	9' *	0'
20'	10' *	0'
22'	10'	1'
24'	10'	2'
26'	11'	2'
28'	12'	2'
32'	12'	4'

* May vary due to pavement width

TWO LANE - TWO WAY ROADWAY		50
MPH OR LESS		
ROADWAY WIDTH	LANE WIDTH	SHOULDER WIDTH
18'	9' *	0'
20'	10' *	0'
22'	10'	1'
24'	10'	2'
26'	11'	2'
28'	11'	3'
32'	11'	5'

* May vary due to pavement width

SCHEMATIC OF ROADWAY

(NOT TO SCALE)

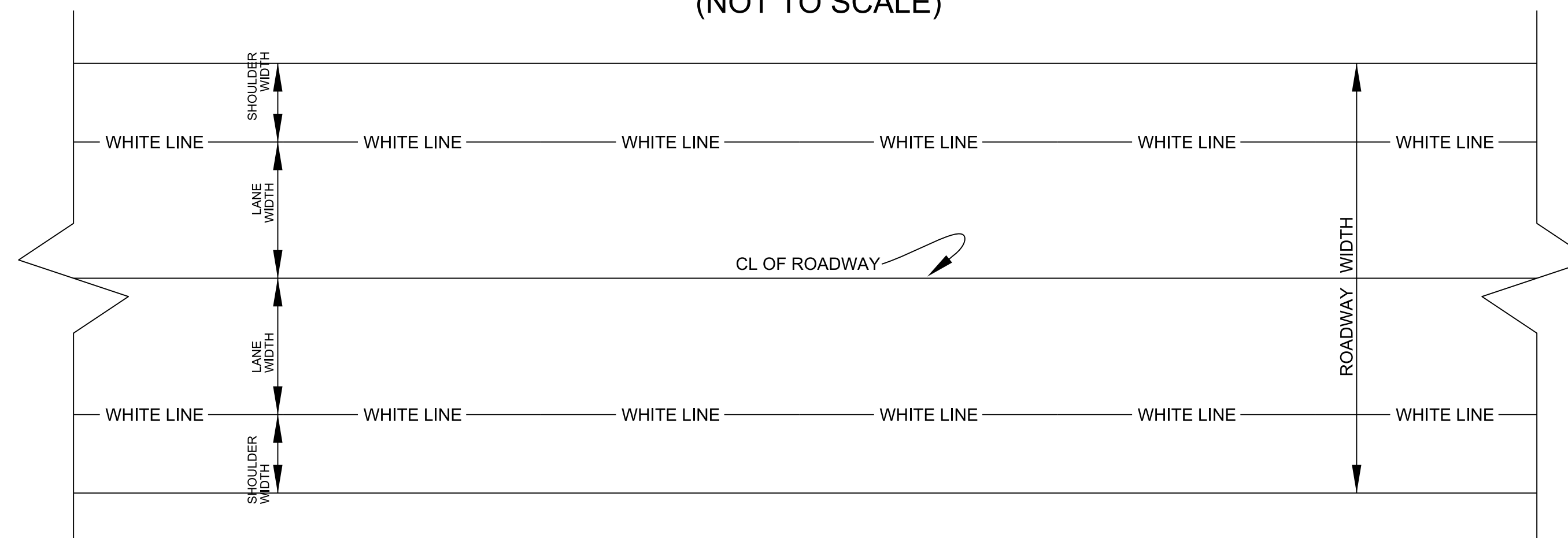

SUMMARY OF QUANTITIES

													PROJECT NO.		SHEET NO.		TOTAL NO.				
													2022CPT.06.06.10781.1, 2022CPT.06.06.20781.1		11						
PROJECT NO	COUNTY	MAP NO	ROUTE	DESCRIPTION	TYP NO	LANES	LANE TYPE	FINAL SURFACE TESTING REQUIRED	WARM MIX ASPHALT REQUIRED	LENGTH	WIDTH	1220000000-E	1245000000-E	1260000000-E	1297000000-E			1330000000-E			
												INCIDENTAL STONE BASE	SHOULDER RECONSTRUCTION	AGGREGATE SHOULDER BORROW	0.75" MILLING	1½" MILLING	5.5" MILLING	INCIDENTAL MILLING			
												MI	FT	TONS	SMI	TON	SY	SY	SY	SY	
2022CPT.06.06.10781.1	Robeson	1	US 301	I-95 (MM 0) TO ROWLAND SCL (MM 2.24)	1	2	2WU	NO	NO	2.24	37	22			48,623			1,667			
TOTAL FOR MAP NO. 1													22			48,623			1,667		
2022CPT.06.06.20781.1	Robeson	2	US 501	NC 130 (MM 10.2) TO SCOTLAND CL (MM 15.52)	1	2	2WU	NO	NO	5.32	27	53			84,269	1,537		3,134			
TOTAL FOR MAP NO. 2													53			84,269	1,537		3,134		
TOTAL FOR PROJ NO. 2022CPT.06.06.10781.1													75			132,892	1,537		4,801		
																134,429					
2022CPT.06.06.20781.1	Robeson	3	SR 1107	US 501 (MM 4.74) TO SC LINE (MM 10.73)	2	2	2WU	NO	NO	5.99	20		11.98	1,997				2,222			
TOTAL FOR MAP NO. 3													5.99			11.98	1,997			2,222	
2022CPT.06.06.20781.1	Robeson	4	SR 1128	SC LINE (MM0.0) TO SR 1101 (MM 1.33)	2	2	2WU	NO	NO	1.33	19		2.66	443				833			
TOTAL FOR MAP NO. 4													1.33			2.66	443			833	
2022CPT.06.06.20781.1	Robeson	5	SR 1129	SR 1107 (MM 1.28) TO SR 1101 (MM 2.89)	2	2	2WU	NO	NO	1.61	20		3.22	524				556			
TOTAL FOR MAP NO. 5													1.61			3.22	524			556	
2022CPT.06.06.20781.1	Robeson	6	SR 1132	SR 1131 (MM 0.0) TO MM 0.4	2	2	2WU	NO	NO	0.40	20		0.80	133				278			
TOTAL FOR MAP NO. 6													0.40			0.80	133			278	
2022CPT.06.06.20781.1	Robeson	7	SR 1132	MM 0.4 TO SR 1131 (MM 0.61)	3	2	2WU	NO	NO	0.21	20		0.42	70			2,464	278			
TOTAL FOR MAP NO. 7													0.21			0.42	70			2,464	278
2022CPT.06.06.20781.1	Robeson	8	SR 1151	SR 1152 (MM 0.0) TO DE (MM 0.55)	2	2	2WU	NO	NO	0.55	18		1.10	184				833			
TOTAL FOR MAP NO. 8													0.55			1.10	184			833	
2022CPT.06.06.20781.1	Robeson	9	SR 1152	SR 1166 (MM 0.00) TO NC 710 (MM 2.45)	4	2	2WU	NO	NO	2.45	18		4.90	817				1,389			
TOTAL FOR MAP NO. 9													2.45			4.90	817			1,389	
2022CPT.06.06.20781.1	Robeson	10	SR 1152	NC 710 (MM 2.45) TO SR 1151 (MM 3.23)	2	2	2WU	NO	NO	0.78	18		1.56	260				278			
TOTAL FOR MAP NO. 10													0.78			1.56	260			278	
2022CPT.06.06.20781.1	Robeson	11	SR 1203	SR 1152 (MM 0.00) TO DEAD END (MM 0.18)	2	2	2WU	NO	NO	0.18	19		0.36	60				278			
TOTAL FOR MAP NO. 11													0.18			0.36	60			278	
TOTAL FOR PROJ NO. 2022CPT.06.06.20781.1													13.50			27.00	4,488		2,464	2,464	6,945
GRAND TOTAL													21.06		75	27.00	4,488	132,892	1,537	2,464	11,746
																		136,893			

PROJECT NO	COUNTY	MAP NO	ROUTE	DESCRIPTION	TYP NO	LANES	LANE TYPE	FINAL SURFACE TESTING REQUIRED	WARM MIX ASPHALT REQUIRED	LENGTH	WIDTH	1491000000-E	1503000000-E	1519000000-E	1523000000-E	1575000000-E	1704000000-E			
												BASE COURSE, B25.0C	INTERMEDIATE COURSE, I19.0C	SURFACE COURSE, S9.5B	SURFACE COURSE, S9.5C	ASPHALT BINDER FOR PLANT MIX	PATCHING EXISTING PAVEMENT			
												MI	FT	TONS	TONS	TONS	TONS	TONS	TONS	
2022CPT.06.06.10781.1	Robeson	1	US 301	I-95 (MM 0) TO ROWLAND SCL (MM 2.24)	1	2	2WU	NO	NO	2.24	37	166			4,280	264	22			
TOTAL FOR MAP NO. 1													2.24			4,280	264	22		
2022CPT.06.06.20781.1	Robeson	2	US 501	NC 130 (MM 10.2) TO SCOTLAND CL (MM 15.52)	1	2	2WU	NO	NO	5.32	27	390			7,410	462	53			
TOTAL FOR MAP NO. 2													5.32			7,410	462	53		
TOTAL FOR PROJ NO. 2022CPT.06.06.10781.1													7.56			11,690	726	75		
2022CPT.06.06.20781.1	Robeson	3	SR 1107	US 501 (MM 4.74) TO SC LINE (MM 10.73)	2	2	2WU	NO	NO	5.99	20	441		6,113		429	30			
TOTAL FOR MAP NO. 3													5.99			6,113	429	30		
2022CPT.06.06.20781.1	Robeson	4	SR 1128	SC LINE (MM0.0) TO SR 1101 (MM 1.33)	2	2	2WU	NO	NO	1.33	19	99		1,323		93				
TOTAL FOR MAP NO. 4													1.33			1,323	93			
2022CPT.06.06.20781.1	Robeson	5	SR 1129	SR 1107 (MM 1.28) TO SR 1101 (MM 2.89)	2	2	2WU	NO	NO	1.61	20	114		1,599		112				
TOTAL FOR MAP NO. 5													1.61			1,599	112			
2022CPT.06.06.20781.1	Robeson	6	SR 1132	SR 1131 (MM 0.0) TO MM 0.4	2	2	2WU	NO	NO	0.40	20	29		420		29				
TOTAL FOR MAP NO. 6													0.40			420	29			
2022CPT.06.06.20781.1	Robeson	7	SR 1132	MM 0.4 TO SR 1131 (MM 0.61)	3	2	2WU	NO	NO	0.21	20	521		421		273				
TOTAL FOR MAP NO. 7													0.21			521	421	273		
2022CPT.06.06.20781.1	Robeson	8	SR 1151	SR 1152 (MM 0.0) TO DE (MM 0.55)	2	2	2WU	NO	NO	0.55	18	40		564		40	6			
TOTAL FOR MAP NO. 8													0.55			40	564	40	6	
2022CPT.06.06.20781.1	Robeson	9	SR 1152	SR 1166 (MM 0.00) TO NC 710 (MM 2.45)	4	2	2WU	NO	NO	2.45	18	1,982		2,780		275	25			
TOTAL FOR MAP NO. 9													2.45			1,982	2,780	275	25	
2022CPT.06.06.20781.1	Robeson	10	SR 1152	NC 710 (MM 2.45) TO SR 1151 (MM 3.23)	2	2	2WU	NO	NO	0.78	18	59		720		51	8			
TOTAL FOR MAP NO. 10													0.78			59	720	51	8	
2022CPT.06.06.20781.1	Robeson	11	SR 1203	SR 1152 (MM 0.00) TO DEAD END (MM 0.18)	2	2	2WU	NO	NO	0.18	19	15		194		14	2			
TOTAL FOR MAP NO. 11													0.18			15	194	14	2	
TOTAL FOR PROJ NO. 2022CPT.06.06.20781.1													13.50		3,300	421	13,986	1,105	71	
GRAND TOTAL													21.06		3,856	421	13,986	11,690	1,831	146

THERMOPLASTIC AND PAINT QUANTITIES

PROJECT NO.	SHEET NO.	TOTAL NO.
2022CPT.06.06.10781.1, 2022CPT.06.06.20781.1	12	

PROJECT NO	COUNTY	MAP NO	ROUTE	DESCRIPTION	TYP NO	LANES	LANE TYPE	LENGTH		WIDTH	4413000000-E	4457000000-N	4685000000-E		4810000000-E		4891000000-E		4892000000-N	4900000000-N		
								MI	FT		WORK ZONE ADVANCE/GENERAL WARNING SIGNING	TEMPORARY TRAFFIC CONTROL	4" X 90 M WHITE THERMO	4" X 90 M YELLOW THERMO	4" WHITE PAINT	4" YELLOW PAINT	24" X 90 M WHITE THERMO	16" X 90 M WHITE THERMO	THERMO RXR 90 M	YELLOW & YELLOW MARKERS		
								SF	LS		LF	LF	LF	LF	LF	LF	EA	EA				
2022CPT.06.06.10781.1	Robeson	1	US 301	I-95 (MM 0) TO ROWLAND SCL (MM 2.24)	1	2	2WU	2.24	37			23,660	20,111	23,660	20,111					155		
TOTAL FOR MAP NO. 1								2.24			251	1	23,660	20,111	23,660	20,111				155		
2022CPT.06.06.10781.1	Robeson	2	US 501	NC 130 (MM 10.2) TO SCOTLAND CL (MM 15.52)	1	2	2WU	5.32	27			56,179	47,751	56,179	47,751					360		
TOTAL FOR MAP NO. 2								5.32			596		56,179	47,751	56,179	47,751					360	
TOTAL FOR PROJ NO. 2022CPT.06.06.10781.1								7.56			847	1	79,839	67,862	79,839	67,862					515	
												147,701		147,701								
2022CPT.06.06.20781.1	Robeson	3	SR 1107	US 501 (MM 4.74) TO SC LINE (MM 10.73)	2	2	2WU	5.99	20					126,509	107,532							
TOTAL FOR MAP NO. 3								5.99			671				126,509	107,532						
2022CPT.06.06.20781.1	Robeson	4	SR 1128	SC LINE (MM 0.0) TO SR 1101 (MM 1.33)	2	2	2WU	1.33	19					28,090	23,874							
TOTAL FOR MAP NO. 4								1.33			149				28,090	23,874						
2022CPT.06.06.20781.1	Robeson	5	SR 1129	SR 1107 (MM 1.28) TO SR 1101 (MM 2.89)	2	2	2WU	1.61	20					33,792	28,722							
TOTAL FOR MAP NO. 5								1.61			176				33,792	28,722						
2022CPT.06.06.20781.1	Robeson	6	SR 1132	SR 1131 (MM 0.0) TO MM 0.4	2	2	2WU	0.4	20					8,448	7,392							
TOTAL FOR MAP NO. 6								0.4			45				8,448	7,392						
2022CPT.06.06.20781.1	Robeson	7	SR 1132	MM 0.4 TO SR 1131 (MM 0.61)	3	2	2WU	0.21	20					4,435	3,881							
TOTAL FOR MAP NO. 7								0.21			24				4,435	3,881						
2022CPT.06.06.20781.1	Robeson	8	SR 1151	SR 1152 (MM 0.0) TO DE (MM 0.55)	2	2	2WU	0.55	18			5,808	5,282				48	380	4	36		
TOTAL FOR MAP NO. 8								0.55			62			5,808	5,282			48	380	4	36	
2022CPT.06.06.20781.1	Robeson	9	SR 1152	SR 1166 (MM 0.00) TO NC 710 (MM 2.45)	4	2	2WU	2.45	18			25,872	21,991							162		
TOTAL FOR MAP NO. 9								2.45			274			25,872	21,991							162
2022CPT.06.06.20781.1	Robeson	10	SR 1152	NC 710 (MM 2.45) TO SR 1151 (MM 3.23)	2	2	2WU	0.78	18			87	8,237	7,207						51		
TOTAL FOR MAP NO. 10								0.78			87			8,237	7,207							51
2022CPT.06.06.20781.1	Robeson	11	SR 1203	SR 1152 (MM 0.00) TO DEAD END (MM 0.18)	2	2	2WU	0.18	19					100	100					2		
TOTAL FOR MAP NO. 11								0.18			20				100	100						2
TOTAL FOR PROJ NO. 2022CPT.06.06.20781.1								13.5			1,508			39,917	34,480	201,374	171,501	48	380	4		251
												74,397		372,875		428						
GRAND TOTAL								21.06			2,355	1	119,756	102,342	281,213	239,363	48	380	4		766	
												222,098		520,576		428						